

NOTICE

The purchaser agrees when purchasing this plan (the "Plan"); the purchaser has acquired the right to build or construct the project or project set out in the Plan for personal use only and not for any commercial use. No reproduction of the Plan in whole or in part by any means whatsoever is strictly prohibited. The Handyman should not be liable for any willful misuse or negligent use of this plan, the Project or any tools used to construct the Project or for any loss or damage resulting therefrom.

NOTE: Read all directions before beginning

Carpenters Glue should be used to reinforce all joints
Set all nails, countersink all screws.
Dimensions in brackets denote millimeters

Directions

1) Lay out your material on the workbench as outlined in the suggested material layout (Fig. 1). Draw out all parts exactly as illustrated in pencil. Ensure to leave a small space between cut lines to allow for the width of the saw. Before cutting, double check all measurements to ensure they are correct. When cutting across the grain tap the edges with masking tape or clamp on 1/8" material to avoid splintering. Always cut on the waste side of the line. Wipe off any excess glue at each stage of the project. Cut the rabbet in A, X, and N as shown (Details A, B, and C) using a table saw or a router. Use the router for moulding R (Detail D). To cut butt and barrel pieces D and E, lay out the grid as shown (Fig 3) and free hand transfer to a thin piece of paper. Cut the paper and lay onto the pieces. Trace around the cuts and cut with a jigsaw. Drill the 9/16" holes in D, B and U as shown in detail E. Note that the hole in the bottom piece B goes only half way through. This is the place that the locking dowel rests on.

OVER

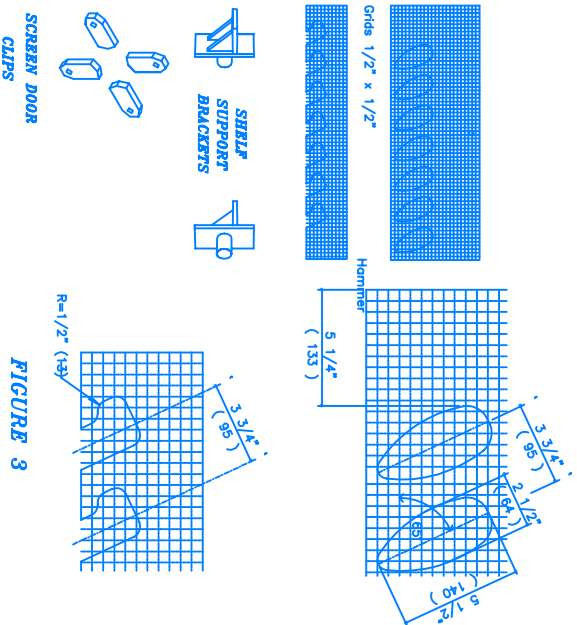
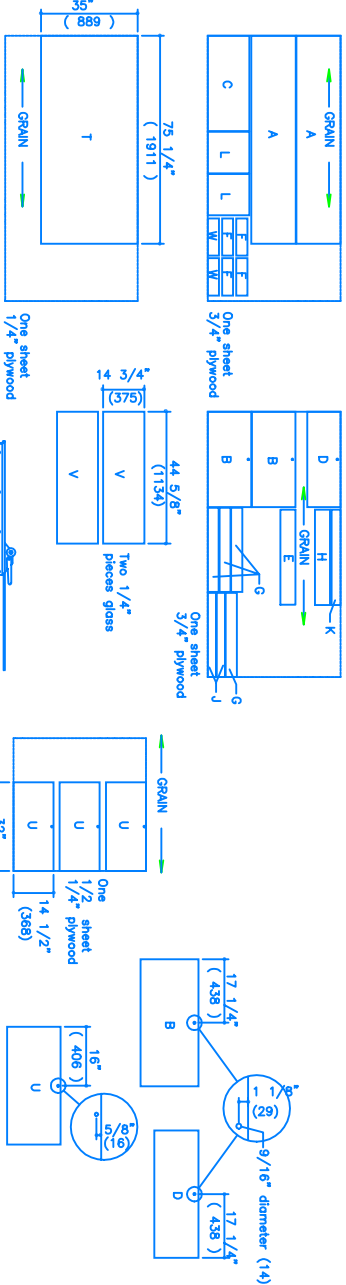
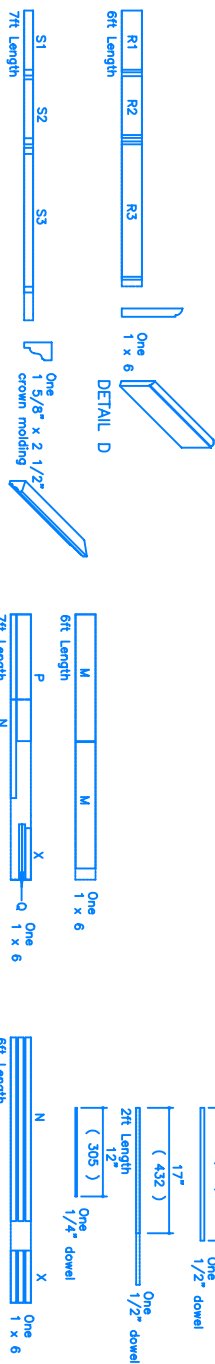
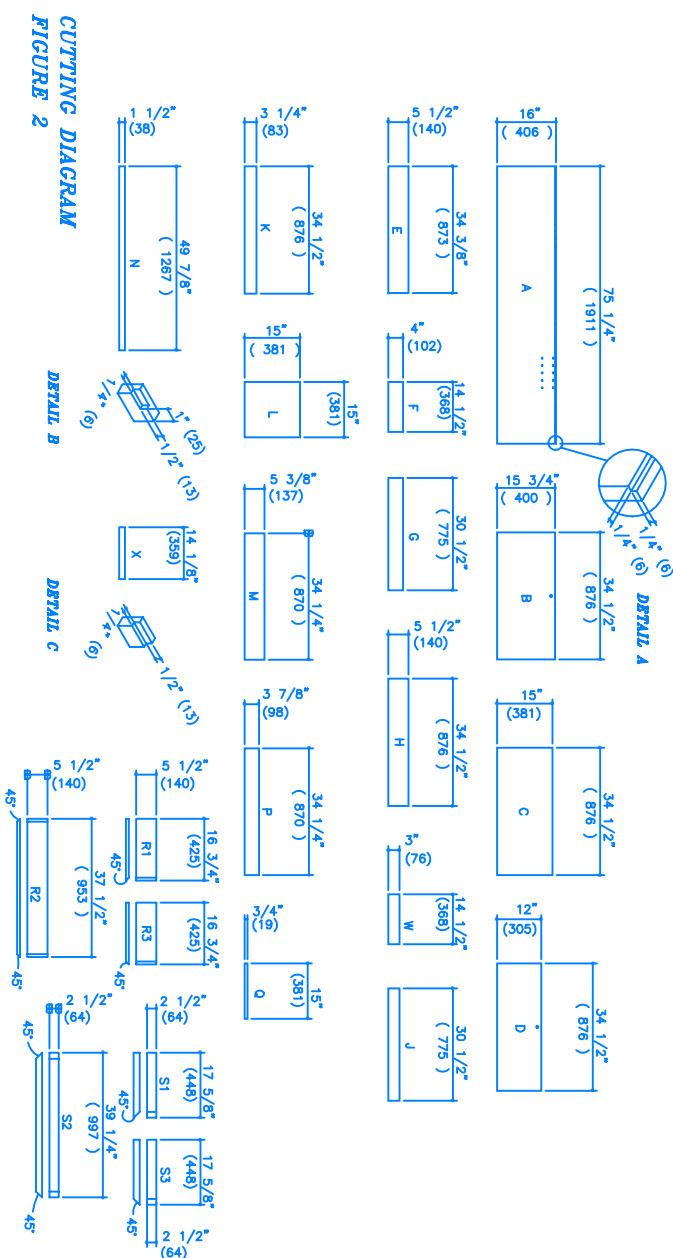

FIGURE 3



MATERIALS LAYOUT
FIGURE 1



CUTTING DIAGRAM
FIGURE 2

- MATERIALS LIST***
- Two 4'x8' sheet 3/4" Plywood, good both sides
 - One 4'x8' sheet 1/4" Plywood, good one side
 - One 4'x8' sheet 1/4" Plywood, good one side
 - Three 6' 1x6 (3/4"x5 1/2")
 - One 7' 1x6 (3/4"x5 1/2")
 - One 7' Crown Moulding (1 5/8"x 2 1/2")*
 - One 12" piece 1/4" wood dowel
 - One 36" piece 1/2" wood dowel
- MATERIALS LIST***
- Two 44 3/4"x14 7/8" glass panels (1/4")
 - Approx. 1 1/2 lb. 1 1/2" finishing nails
 - Approx. 1/2 lb. 3/4" finishing nails
 - Approx. 1/2 lb. #8 finished screws
 - Approx. Twenty 2 1/2" #8 finished screws
 - Approx. Ten 1 1/4" #8 finished screws
 - Twenty plastic screen clips
- MATERIALS LIST***
- Three sets 14" bottom mount drawer guides
 - Two 48 3/4" x 1 1/2" x 1 1/2" finishing nails
 - Two Cupboard pulls & three matching
 - Door Pulls with hardware
 - Four shelf brackets (1/4" inset dia.)
 - Five 8" edgetape
 - Two magnetic catches
- MATERIALS LIST***
- Stain and varnish, or oil
 - 12" finisher, light sandpaper (optional)
 - Sandpaper & Carpenter's glue
 - Two Barrel Bolts
 - One Cabinet Door lock
- * The moulding can be eliminated if you wish to be creative with your router & a 2x4